

## MaiA DS - My Audio Integrated Amplifier

Stereo integrated amplifier with 9 inputs & App control

- Powerful 55 watts per channel (2 ohms drive capability)
- 2x 80 watts with optional linear supply Power Box MaiA DS
- Dual mono design principle
- Built-in phono pre-amplifier with MM & MC capability
- Other inputs: 3x analogue, 5x digital including USB 2.0
- XMOS asynchronous USB 24bit/192kHz
- DSD capability (DSD64, DSD128; DSD256)
- Superb dual 24bit/192kHz D/A converter PCM1796
- 4th generation Bluetooth with aptX capability & antenna
- Volume control with motor driven potentiometer
- Headphone output with dedicated amplifier stage
- Fixed & variable outputs for subwoofer or second zone amp
- IR remote & Built-in App Remote Control via Bluetooth
- Free Box Control App controls this + other IR equipment
- Full metal casing with TPE damping feet
- Silver or black faceplate

### Technical data

Power output	2x 40 W / 55W at 8 / 4 ohms
Signal-to-noise ratio Line/MM/MC	> -90dB / -90dB / -75dB (IEC A-weighted)
Channel separation	> -65dB
THD +N	< 0,07% @ 15W
Frequency response	20Hz - 20kHz (+0,2dB, -2,5dB)
Analogue inputs	3 pair RCA/Cinch sockets line 1 pair phono MM/MC input (RCA)
Input impedance	Line: 50kohms, Phono: MM 47kohms / MC 100 ohms
Digital inputs	USB, RCA coax, 2 Toslink, Bluetooth (aptX)
D/A converter	TI PCM1796 Delta-Sigma
Speaker connectors	4mm Ø banana plugs, spades connectors or naked wire
Headphone output	6,3mm jack
Headphone impedance	16 - 600ohms recommended
Line outputs	fixed, variable (subwoofer, power amp)
Power supply	24V/5A DC; 100 - 240V, 50/60Hz
Standby Power consumption	< 0,5W
Dimensions W x H x D	206 x 72 x 150 (165mm with sockets)
Weight	1550 g without power supply



### MaiA DS: A new generation stereo amplifier with superior sound, App control & future-proof technology!

This small integrated amplifier offers outstanding audio quality and ultimate input flexibility with all digital and analogue input options you can dream of. Superior tube-like sound and a high-class 24bit/192kHz D/A converter stage are combined in a perfect way. Despite its small size, 9 (!) source devices can be connected simultaneously. MaiA DS is future-proof and can be upgraded with Power Box MaiA DS for almost double power. Power Box MaiA DS acts as „One power supply“ solution and powers up to 5 Pro-Ject products, like CD, Streamer and turntable. Control via IR remote or App makes usage a piece of a cake. The massive metal casing is elegant and protects effectively against interferences. MaiA DS is available with silver or black faceplates.

## Free control App

(see page 2)



## MaiA DS - 9 (!) audio inputs can be connected simultaneously



- ⇒ Additionally a subwoofer or power amplifier can be connected.
- ⇒ A dedicated headphone amplifier stage with 6,3mm connection is provided.

## MaiA DS - Free App control (built-in Remote Box functionality)

*What makes this amplifier absolutely unique* is the built in Box Control system, which allows easy control of this and other IR controlled devices from Pro-Ject via free App. If a mobile device with activated Bluetooth (paired with MaiA DS) control does not need WiFi environment at all. System is working even during Bluetooth music playback.

- Controls IR devices
- No Wi-Fi needed
- Full control via Bluetooth
- Android-App is available (Apple will follow)
- Pre programmed Box Design devices
- Controls Stream Boxes, MaiA DS, CD player ...

Free control App

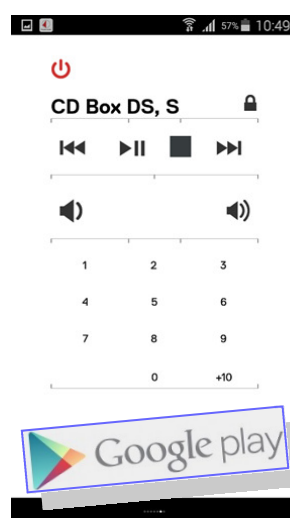
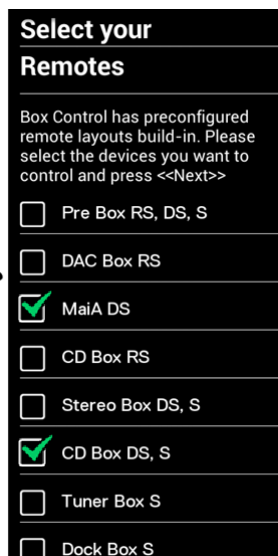
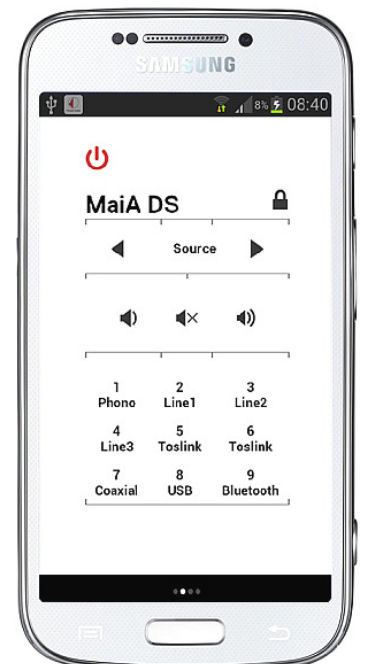

## Power Box MaiA DS

- Optional upgrade
- Almost doubles dynamic power for MaiA DS with 2x 80 watts @ 4 ohms (double mono amp)
- Power Box MaiA DS acts as „One power supply“ solution
- Powers MaiA DS powers up to 4 more Pro-Ject products, like CD, Streamer and turntable.

Power Box MaiA DS  
SRP  
**499,00 €**



## MaiA DS - Design Box options

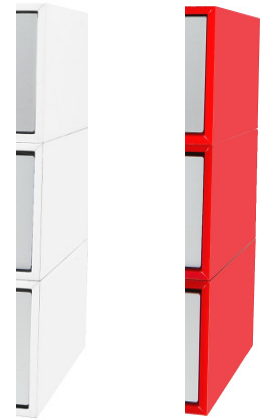

## MaiA DS - complete hifi system with App control

